



STRAIGHT ELECTRODES, POINTED NOSE
"A" NOSE

FEATURES AND SPECIFICATIONS



Features and Benefits

- Long lasting, heavy duty electrode
- Can be used in many job shop applications
- Works with all industry standard holders
- Can be redressed many times
- Available in 3 standard materials
- "A" Nose good for most applications
- Option larger diameter available upon request

Use With

- 4RW or 5RW CMW Holders

Mechanical

- Electrical conductivity up to 90% IACS
- Rockwell hardness up to 100 HRB

ELECTRODES
STRAIGHT

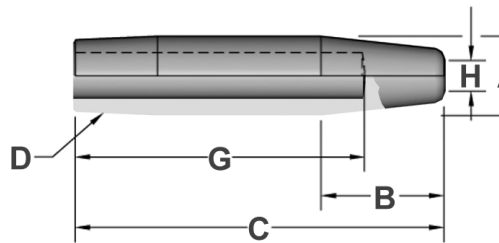

ORDERING INFORMATION AND DIMENSIONS

RWMA	OVERALL LENGTH	HOLE DEPTH	ORDER NO.			NOSE LENGTH	MAJOR DIA.	FACE DIA.
			MATERIAL					
			CMW®28 Class 1	CMW®3 Class 2	CMW®100 Class 3			
D	C	G		B	A	F		
4	1	5/8	1211	3211	5211	3/8	.482	3/16
	1-1/4	3/4	1212	3212	5212	3/8		
	1-1/2	1	1213	3213	5213	5/8		
	1-3/4	1-1/4	1214	3214	5214	3/4		
	2	1-1/2	1215	3215	5215			
	2-1/4	1-3/4	1216	3216	5216			
	2-1/2	2	1217	3217	5217			
	2-3/4	2-1/4	1218	3218	5218	3/4		
	3	2-1/2	1219	3219	5219	3/4		
	3-1/4	2-3/4	12112	32112	52112			
	3-1/2	3	12114	32114	52114			
	3-3/4	3-1/4	12116	32116	52116			
	4	3-1/2	12118	32118	52118	3/4		

RWMA	OVERALL LENGTH	HOLE DEPTH	ORDER NO.			NOSE LENGTH	MAJOR DIA.	FACE DIA.
			MATERIAL					
			CMW®28 Class 1	CMW®3 Class 2	CMW®100 Class 3			
D	C	G		B	A	H		
5	1-1/4	3/4	1222	3222	5222	1/2	.625	1/4
	1-1/2	3/4	1223	3223	5223	3/4		
	1-3/4	1	1224	3224	5224	3/4		
	2	1-1/4	1225	3225	5225	1-1/8		
	2-1/4	1-1/2	1226	3226	5226			
	2-1/2	1-3/4	1227	3227	5227			
	2-3/4	2	1228	3228	5228	1-1/8		
	3	2-1/4	1229	3229	5229			
	3-1/4	2-1/2	12212	32212	52212			
	3-1/2	2-3/4	12214	32214	52214			
	3-3/4	3	12216	32216	52216	1-1/8		
	4	3-1/4	12218	32218	52218	1-1/8		
	4-1/4	3-1/2	12220	32220	52220			
	4-1/2	3-3/4	12222	32222	52222			